

Climatica Basic WEATHER STATION Installation Instructions

Models: 352 0200 001 (miles/hr)
 352 0200 002 (km/hr)
 352 0200 003 (metres/sec)

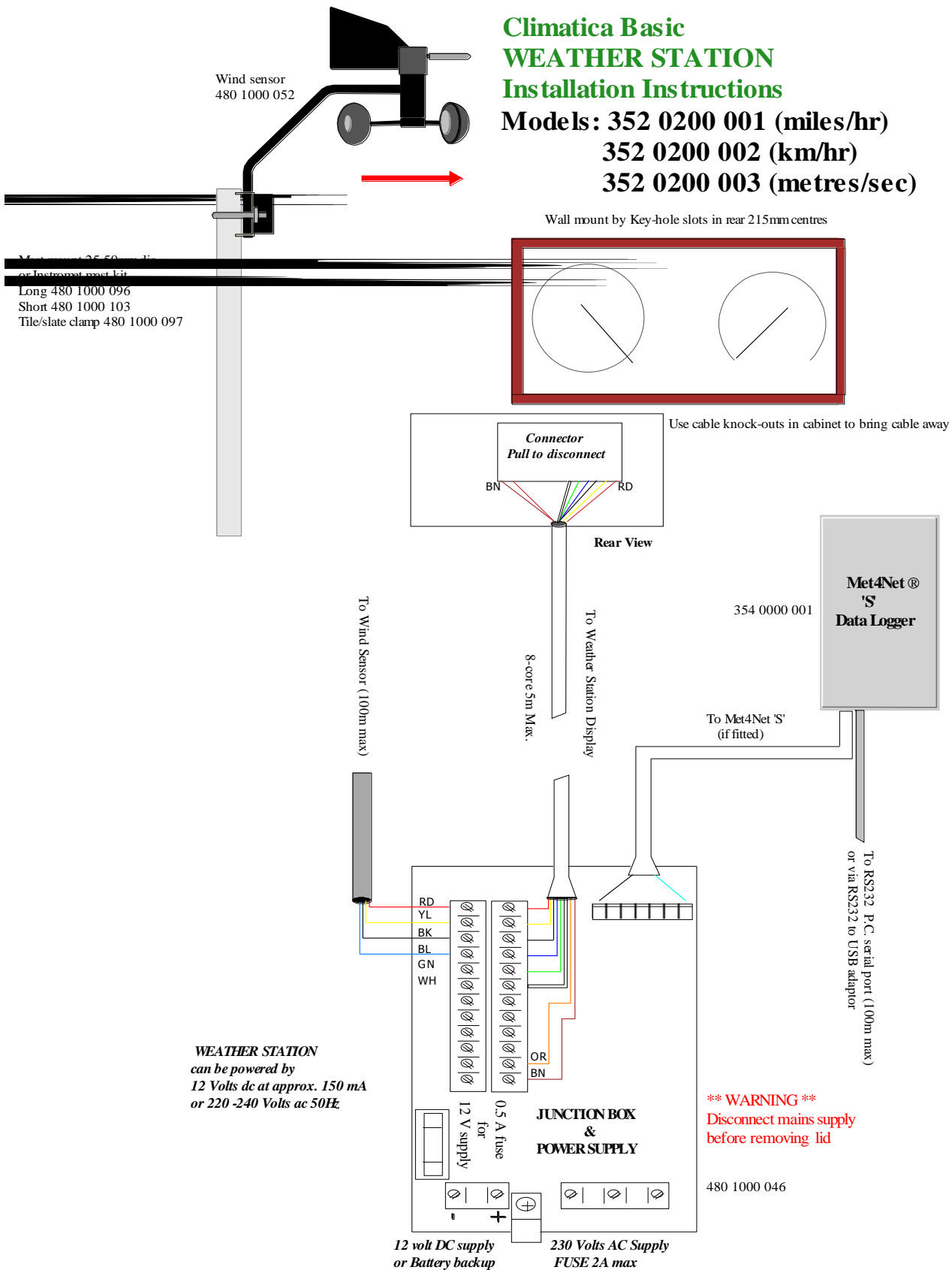

SPECIFICATION

Display unit size: 310 wide x 176mm high x 61mm deep

Display parameters:

Wind direction: Analogue read-out 4 cardinal points sub-divided into 5 degree increments, electronically damped.

Accuracy: ± 10 degrees, resolution > 10 degrees

Wind speed: Analogue read-out with gust indicator pointer, calibrated 0- 90 mph, 0-80 knots and Beaufort scale.

Alternative kph and metres/second scales are available (see Model Numbers on front sheet)

Accuracy: $\pm 5\%$ or 3 knots

Barometer: Analogue read-out with set pointer reset, range 950 -1050 mBar (28 -31 inches Hg)

SENSORS

Roof-mounted wind speed and direction sensor with mounting clamps for easy installation on mast diameter 25 – 50mm.

Data cable length: 25m standard pre-wired (additional cable lengths are available when ordering).

Materials: sensor assemblies utilise anodised aluminium alloy, stainless steel, nylon, injection moulded polypropylene anemometer cups.

Compass provided to align wind sensor arm to North.

POWER SUPPLY

220 – 240Vac 50Hz or 110Vac 60Hz moulded plug-in power supply unit. Alternative 12Vdc may be Customer supplied.

OPTIONAL EXTRAS

Met4Net[®] 'S' Part No. 354 0000 001: Data logger to PC RS232 serial port connectivity or via USB serial port adaptor cable (separately purchased from Instromet Ltd. Part No. 269 1002 001)

Software: Met4Net[®] bespoke software for data recording Part No. 356 0000 001.

Mounting Kits: Aluminium masts 36" long x 1½" diameter

Mast couplers for joining two masts i.e.6'

Wall bracket with mast clamps

} Part No. 480 1000 096

or Roof/slate mounted mast kit for non-chimney dwellings Part No. 480 1000 097

Autostation: Automatic Weather Station & Met4Net[®] software Part No. 355 0000 001/002/003 for 240V/110V/220V respectively.



Installation Instructions

Weather Stations consist of a master display unit, a combined wind speed and direction sensor connected by a four-core cable and a separate junction box/power supply

Roof Top Wind Sensor

The four core cable should be connected to the terminal block on the sensor bracket. This can be accessed by removing the black cover, where a wiring identification label will be found. This unit should be mounted on a mast of 25-50mm diameter (suitable mast mounting solutions are available from Instromet sales), as high and as far away as possible from chimneys, roof peaks, buildings, trees and transmitter aerials which may cause wind turbulence or interference. Where possible the roof top wind sensor should be mounted at least 2 metres above roof peaks and is secured in position with the arm pointing accurately to the NORTH using the compass provided.

The cable from the roof top wind sensor should be run down to the junction box, making sure it is properly secured. Please note! This cable should not be run in close proximity to power or transmitter cables. If it is necessary to shorten the cable please do this when connecting the cable to the display unit.

WARNING: Under no circumstances should the wind sensor junction box cover or the terminal block inside be sealed in any way as it is designed to breathe.

Junction Box & Power Supply

This unit allows the wiring from the sensors to be terminated away from the main display cabinet and a single multi-core cable to be wired to the display. Five metres (15 ft) of cable are supplied which may be shortened if required.

The mains power supply is wired to this unit and care should be taken to ensure that the correct fuse is used i.e. 2 - 5Amp.

Display Unit

The illuminated display unit should be wall mounted by the two keyhole slots in the back panel (215mm centres). The cable may be either channelled into the wall or brought out the side of the cabinet by using the cable knockout holes at each side and at the bottom of the cabinet. Please make sure no dust gets into the display unit.

The display unit is connected to the junction box by an 8-core cable fitted to a 12-way plug. When connecting please ensure that the connector is the correct way round.

Operating Instructions

Gust Pointer

Rotate the gust knob anti-clockwise until it connects with the wind speed pointer. It will now be carried up to show the maximum speed.

Troubleshooting Guide.

You've installed your Weather Station and find that despite careful attention to detail, it does not work as expected. The following notes may assist in getting your Weather Station working.

Nothing appears to work.

Check that the power supply is turned on at the wall socket. Check power cable correctly wired to the correct terminals in the Junction Box. If the lamps inside the unit are illuminated then the power to the instrument is correctly wired and working.

Wind Direction wrong

If Wind Direction gives the wrong reading, check that the wind sensor has been mounted to point North. If the pointer is permanently displaying a Northerly or North North East wind direction then the wind sensor is not connected to the instrument or is incorrectly wired. Note that if the wind sensor is incorrectly wired then neither wind speed nor direction will work.

Wind Speed not working

Check anemometer cups are turning freely and if so wiring is correct (particularly the *blue* wire from the Wind Sensor) and the cable not damaged.

If all fails call service department **01692 502800** or return the sensor to us for checking or replacement.

Instromet Ltd. (A Novomec Group company)
Lyngate Industrial Estate
North Walsham
Norfolk NR28 0AW

Disclaimer

As part of our ongoing policy to improve the design and specification of our products, we reserve the right to change any detail given without prior notice. The Novomec Group shall not be responsible for any liability or loss of any nature which may result from the use of any information provided in technical literature. Instromet® products are designed to monitor current and previous weather conditions for domestic use and should not be considered as predictive weather forecasting equipment. Contact your regional Met Office centre if you need weather forecasting data

www.metoffice.gov.uk

Our products are tested in-house for operation and functionality but have not been independently tested by a UKAS accredited laboratory.